

PUDUCHERRY MUNICIPALITY

DELIMITATION OF MUNICIPAL WARDS - 2014

DRAFT WARD MAP

WARD NO : 5
 WARD NAME : V.O.C NAGAR
 POPULATION : 7593 (As per 2011 Census)

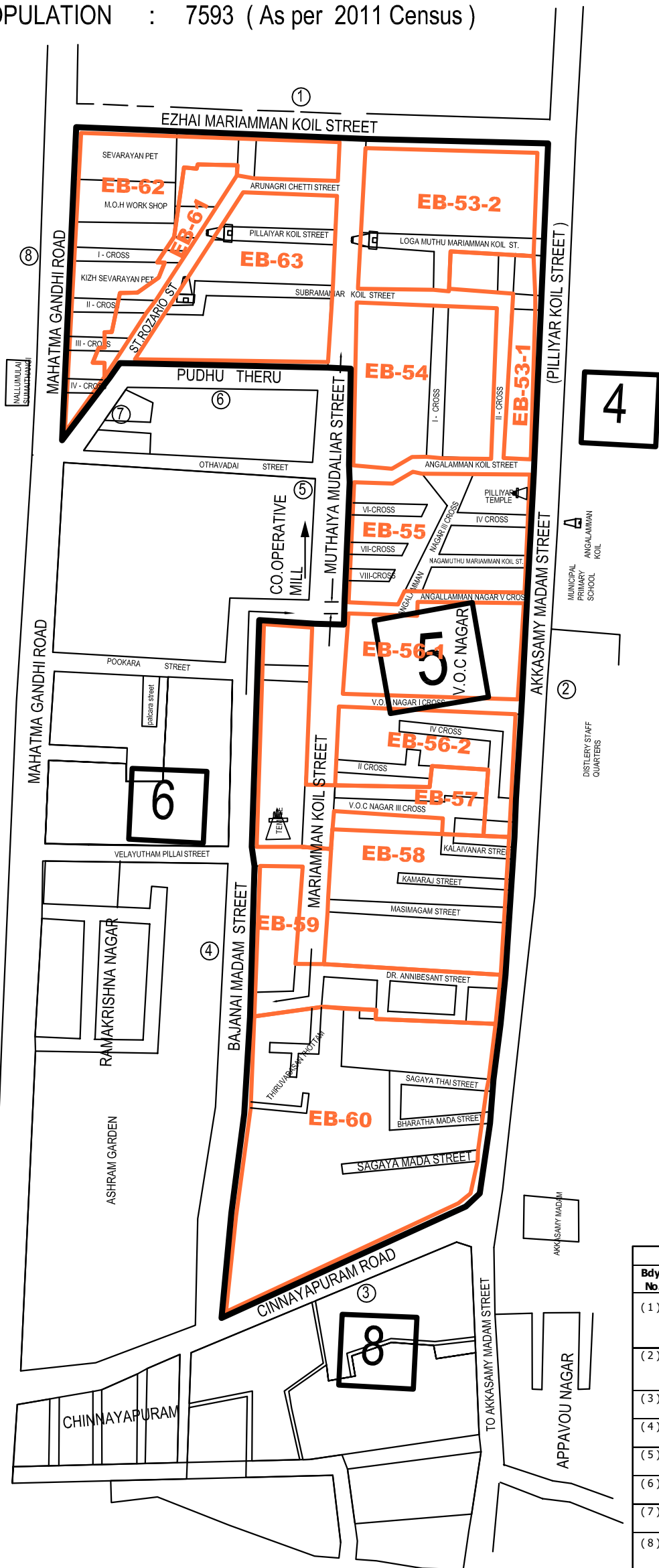
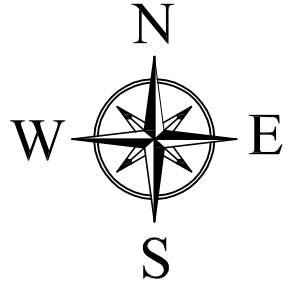

Census Enumeration Block Wise Asper 2011 Census		
Sl. No.	E.B. No.	Population
1	005301	465
2	005302	430
3	005400	796
4	005500	869
5	005601	359
6	005602	539
7	005700	727
8	005800	621
9	005900	666
10	006000	673
11	006100	190
12	006200	450
13	006300	808
Total		7593

List of Boundaries		
Bdy. No.	Boundaries	Direction
(1).	Ezhai Mariamman Koil Street - Southern Edge (M.G. Road to Accasamy Madam St.)	North - West, North & North - East
(2).	Accasamy Madam Street - Western Edge (Ezhai Mariamman Koil Street to Chinnayapuram Road)	East & North - East
(3).	Chinnayapuram Road - Northern Edge (Accasamy Madam St. to Bajana Madam St.)	
(4).	Bajana Madam Street - Eastern Edge (Chinnayapuram Road to Mariamman Koil St.)	South - East
(5).	Muthaiya Mudaliar Street - Eastern Edge (Mariamman Koil Street to Pudhu Theru)	
(6).	Pudhu Theru - Northern Edge (Muthaiya Mudaliar St. to St. Rozario Street)	South
(7).	St. Rozario Street - Western Edge (Pudhu Theru to M.G. Road)	South - West
(8).	Mahatma Ganthi Road - Eastern Edge (St. Rozario St. to Ezhaimariamman Koil St.)	South - West, West & North - West